

ASK
DISTRIBUTION

200-K35001

VELOREX



Velorex: Jedinečné tříkolové vozítko s plátěnou karoserií

Velorex je jediné homologované vozidlo s plátěnou karoserií na světě, vytvořené bratry Františkem (1914–1954) a Mojmírem (1924–2011) Stránskými po druhé světové válce. Původně nazývaný OS-KAR ("kára na ose"), byl navržen jako cenově dostupný dopravní prostředek. Po znárodnění v roce 1948 se výroba přesunula do Solnice a vozidlo bylo přejmenováno na Velorex.

Vyrobeno bylo přibližně 15 300 tříkolových a 1 380 čtyřkolových modelů s motory o objemu 175 cm³ a 350 cm³, známých jako Velorex 16/175 a Velorex 16/350. Díky své jednoduchosti a dostupnosti si Velorex získal popularitu nejen v Československu, ale i po celém světě. Dnes je ceněn sběrateli a lze jej nalézt v Evropě, Asii, Americe a dokonce i v Austrálii.



Velorex: The Iconic Three-Wheeled Vehicle with a Canvas Body

The Velorex is the world's only homologated vehicle with a canvas body, created by brothers František (1914–1954) and Mojmír (1924–2011) Stránský after World War II. Originally called OS-KAR ("cart on an axle"), it was designed as an affordable means of transportation. Following nationalization in 1948, production moved to Solnice, and the vehicle was renamed Velorex.

Approximately 15,300 three-wheeled and 1,380 four-wheeled models were produced, featuring 175 cc and 350 cc engines, known as Velorex 16/175 and Velorex 16/350. Due to its simplicity and affordability, the Velorex gained popularity not only in Czechoslovakia but worldwide. Today, it is valued by collectors and can be found in Europe, Asia, America, and even Australia.

A

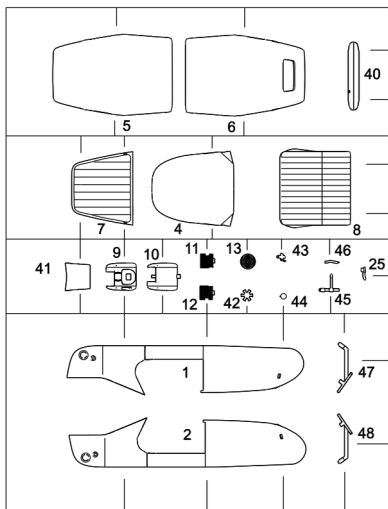

B

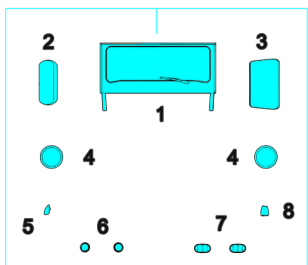
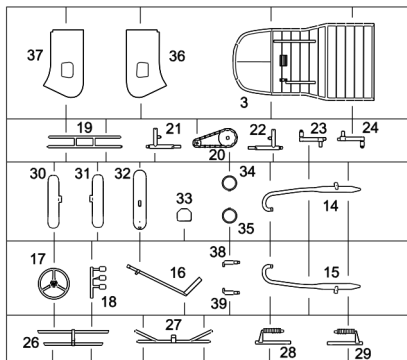

Clear parts

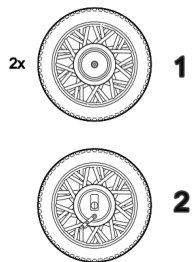

Print parts

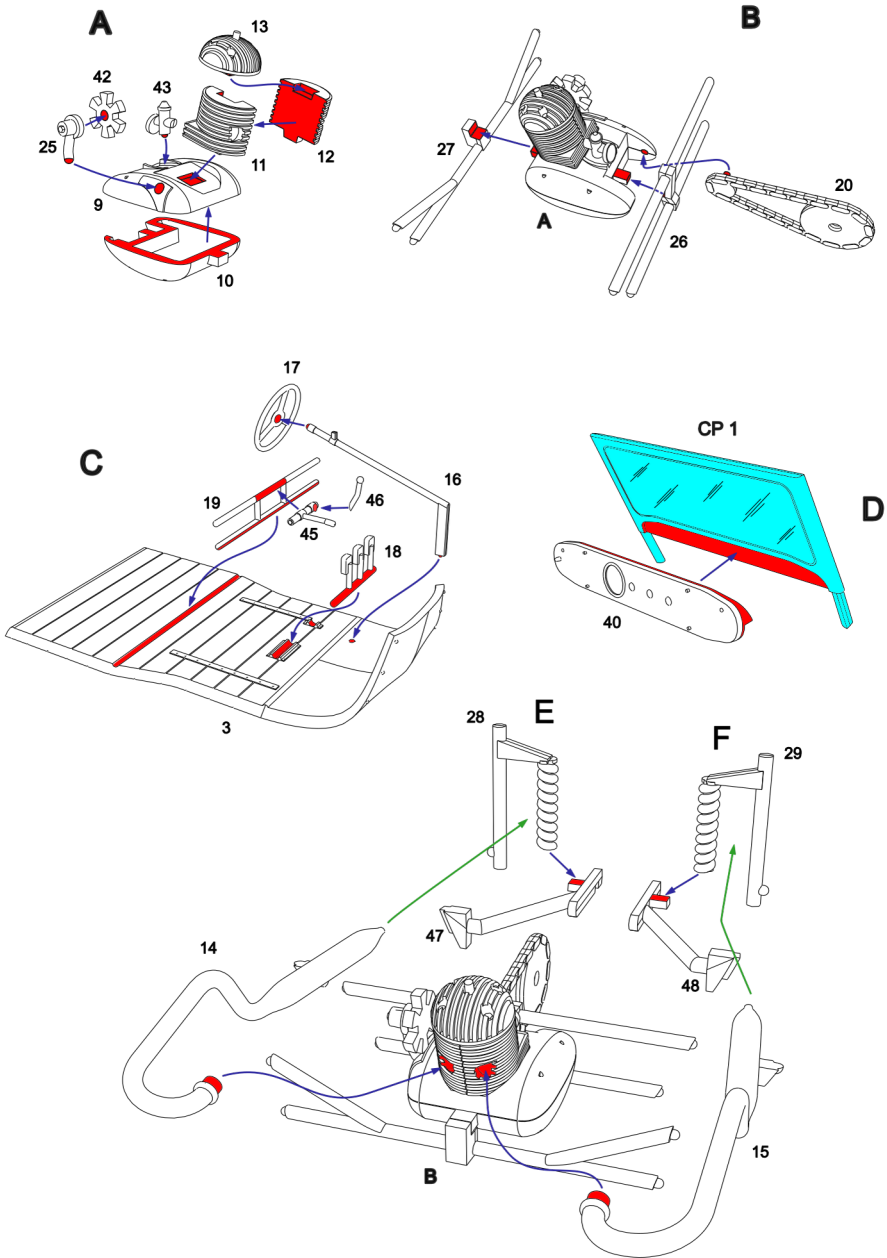

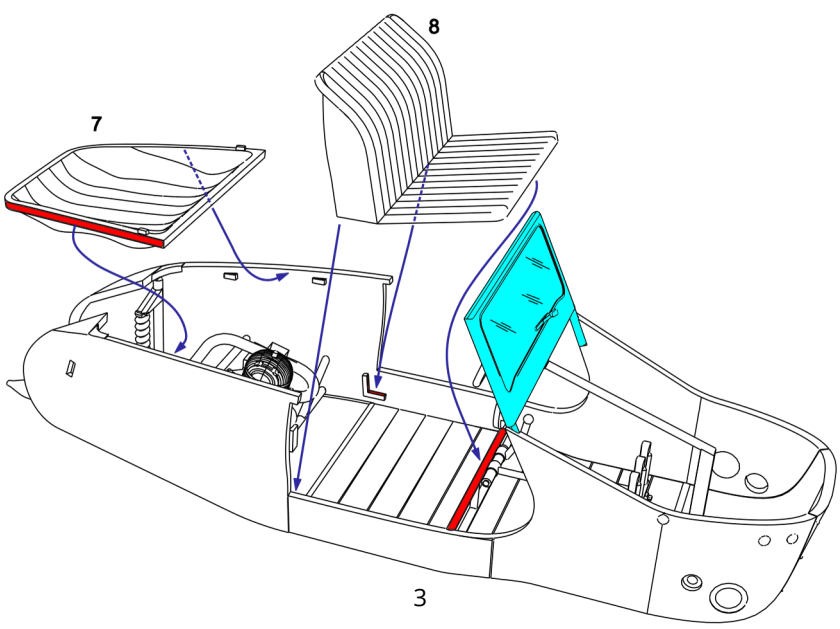
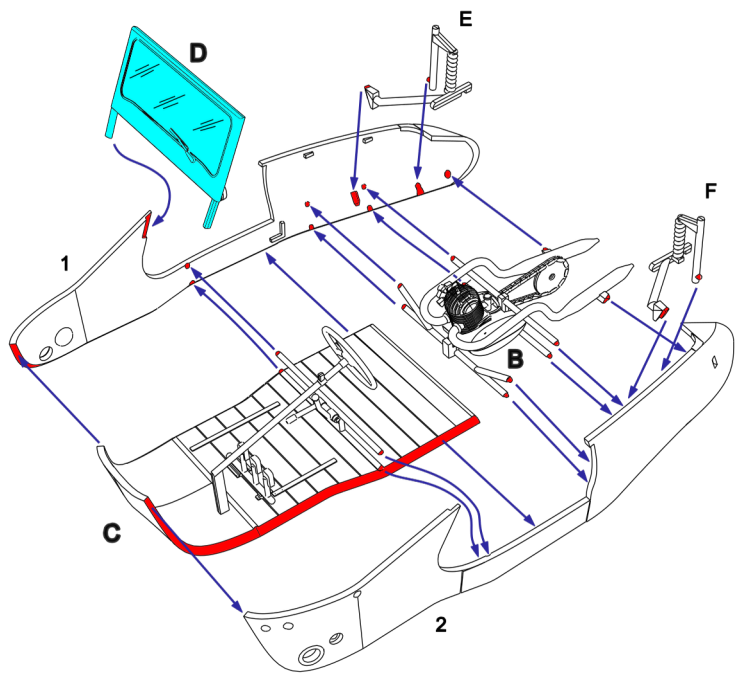

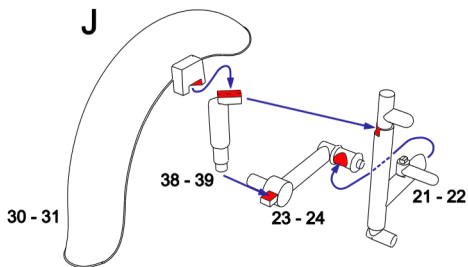
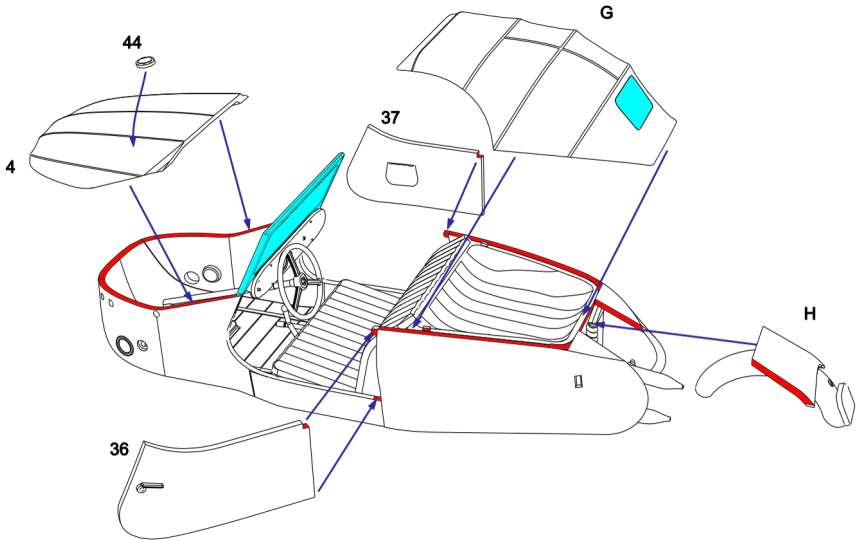
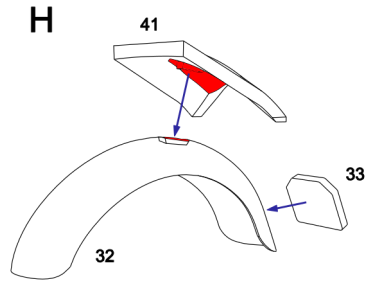
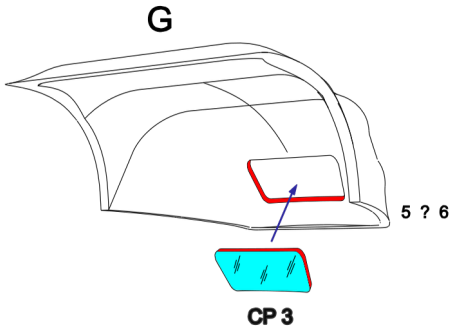

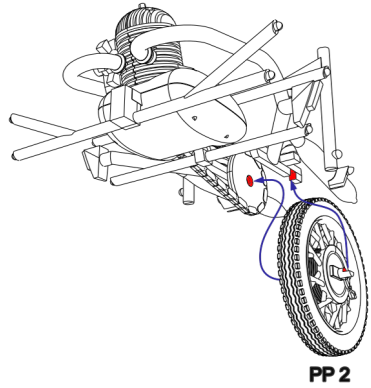
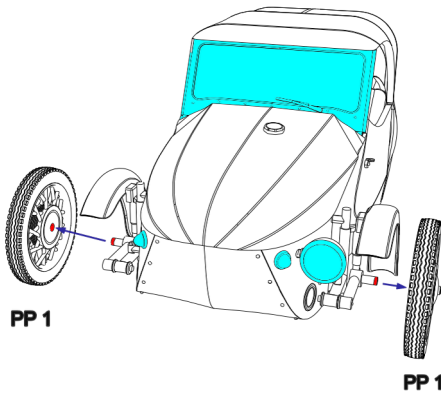
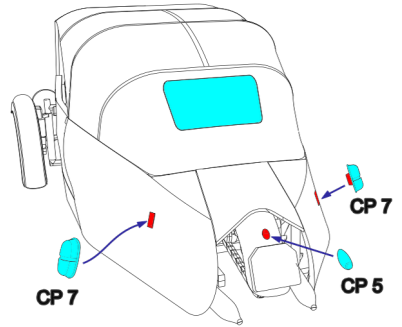
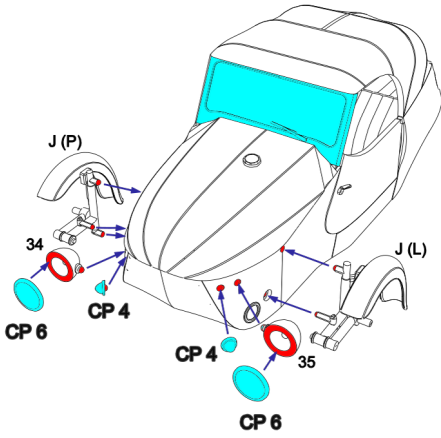

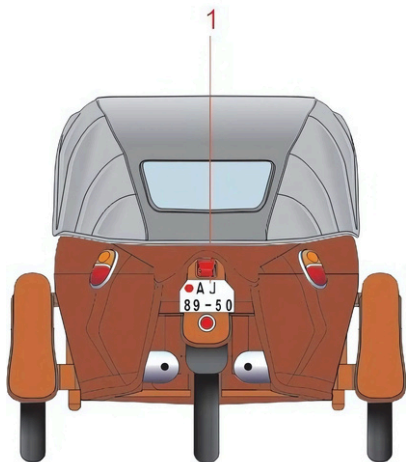
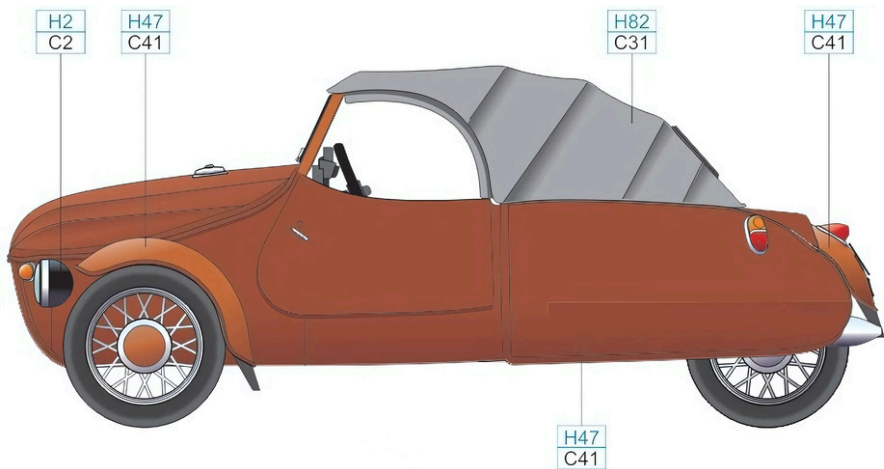

7

RED BROWN H47
C41

DARK GRAY H82
C31

BLACK H2
C2

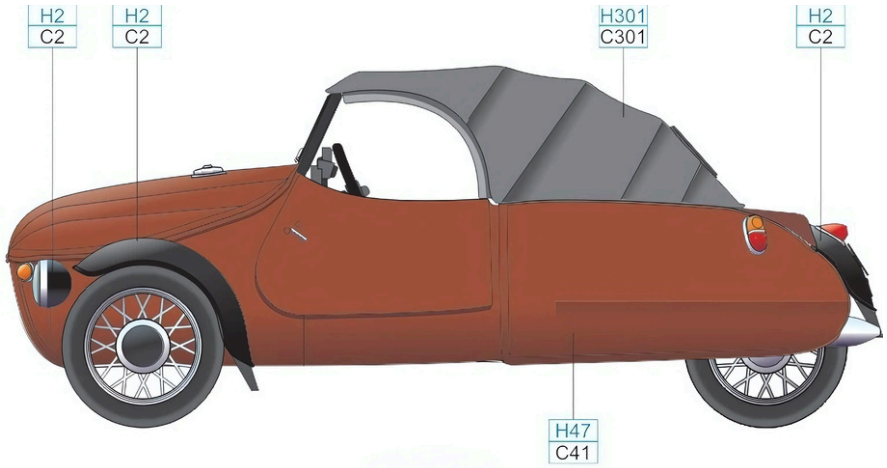

RED BROWN H47
C41

GRAY H301
C301

BLACK H2
C2

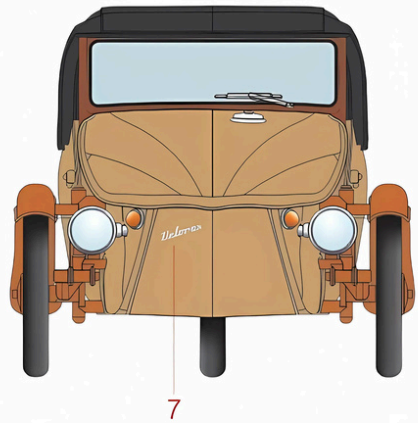
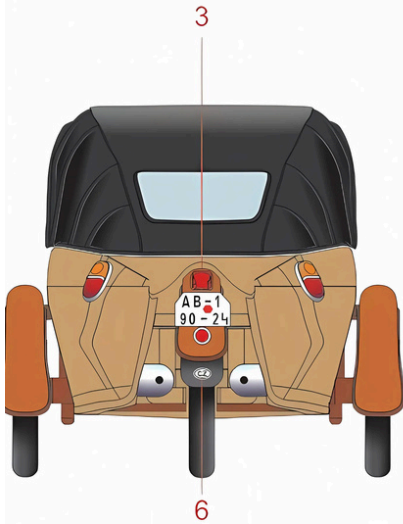
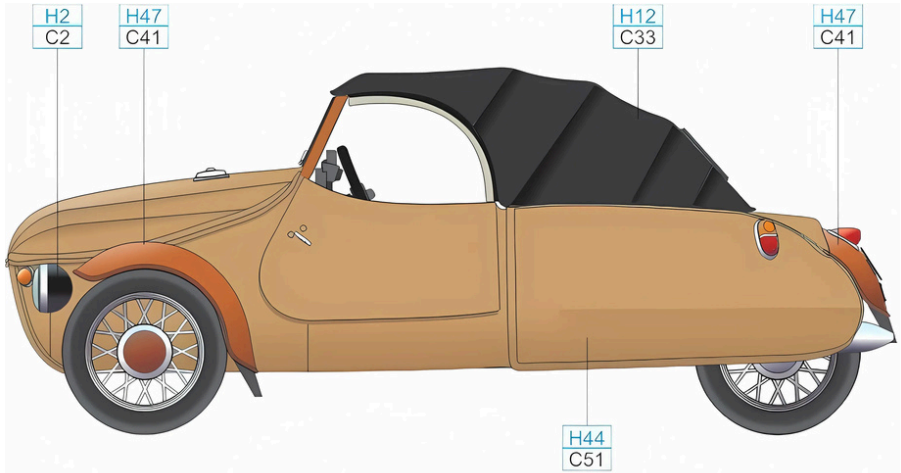

FLESH	H44 C51	BLACK	H12 C33	RED BROWN	H47 C41	BLACK	H2 C2
-------	------------	-------	------------	-----------	------------	-------	----------

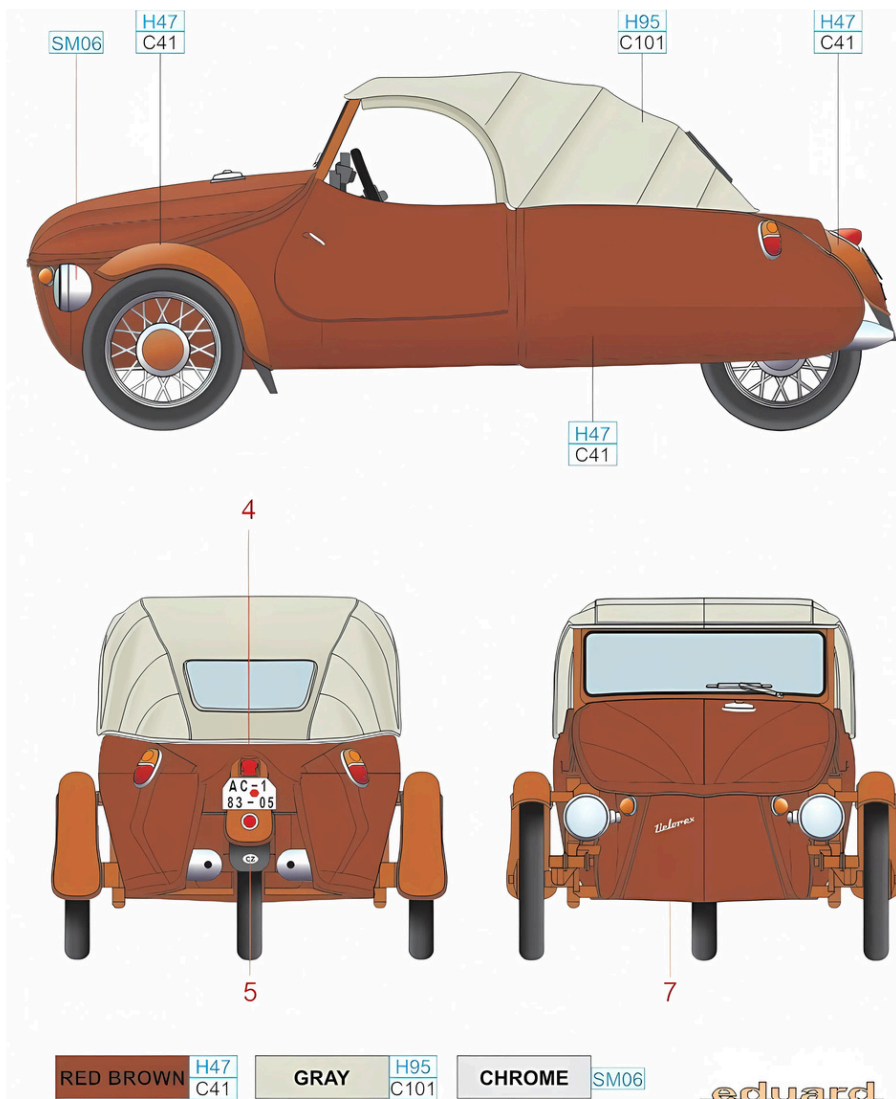

Barevná schémata byla použita s laskavým svolením firmy Eduard.
 The color schemes were used with the kind permission of Eduard.



VELOREX



Stavba modelu Velorexu od Marka Hlůška.
Velmi děkujeme za úžasnou spolupráci!

The Velorex model build by Marek Hlůšek.
We sincerely appreciate the fantastic collaboration!



Velorex Velorex

1950 - 1954

1954 - 1973

Tento model vznikl ve spolupráci s Velorex Clubem v AČR. Děkujeme Velorex Klubu AČR za jejich odbornou podporu a cenné podklady.

This model was created in collaboration with the Velorex Club AČR. We extend our thanks to the Velorex Club AČR for their expert support and valuable resources.

